

Plan Showing The Construction Of
 A House In Plot No. A, In S.No. 34/2B
 Of No. 170, Irumbuliyur Village,
 Saidapet Taluk, Chingleput District

Scale - 1" = 8'-0" Drawing No - 6/1/90

Reference
 DOOR - D - 3'-3" x 6'-6" - 1.00 x 1.98m
 DOOR - D₁ - 3'-0" x 6'-6" - 0.92 x 1.98
 DOOR - D₂ - 2'-6" x 6'-6" - 0.76 x 1.98
 WINDOW - W - 4'-0" x 4'-0" - 1.22 x 1.22
 WINDOW - W₁ - 3'-0" x 4'-0" - 0.92 x 1.22
 WINDOW - W₂ - 4'-0" x 3'-0" - 1.22 x 0.92
 VENTILATOR - V - 3'-3" x 1'-6" - 1.00 x 0.50
 ALL JOINERY IN WELL SEASONED WOOD

Note	SFT	Sq.M	Colour Index
PLOT AREA -	1377	128	EXG. ROAD SHOWN THUS -
PLINTH AREA INCLUDING SITOUT	796	74	EXG. WORK SHOWN THUS -
CARPET AREA INCLUDING SITOUT	658	61	BOUNDARY LINE SHOWN THUS -
			DRAINAGE LINE SHOWN THUS -

Rao Engineering
 Consultancy Services
 No. 24, MUNICIPAL BUILDING,
 SHUNMUGAM ROAD,
 WEST TAMBARAM, MS 45.

Planning Permit No. A/534/96

APPROVED

SUBJECT TO THE CONDITIONS IN THIS PERMIT

No. A/12657/89 dt. 2.05.90

S. Jayan

FOR MEMB. STAFF BY
 MADRAS METROPOLITAN
 DEVELOPMENT AUTHORITY
 MADRAS 600 008

Staircase Details
 WIDTH - 3'-0" - 0.92m
 TREAD - 0'-10" - 0.25m } ONE
 RISE - 0'-7" - 0.18m } FLIGHT

C. A. VARDEVA RAO, Dip. C.E. AFFIET (Lond)
 L.I.C. PANEL VALUER
 PANEL ENGINEER/VALUER FOR
 S.B.I., I.O.B., &
 GEN. INSURANCE COMPANIES,
 LICENSED SURVEYOR FOR
 MADRAS CORPORATION (No. 221),
 TAMBARAM & MANDAL MUNICIPALITIES,
 Off. 24, MUNICIPAL BUILDINGS,
 SHANMUGAM ROAD, TAMBARAM,
 MADRAS-600045.
 Phone: Off. 401957, Res: 403673

x P. S. Jayaram
 Owner

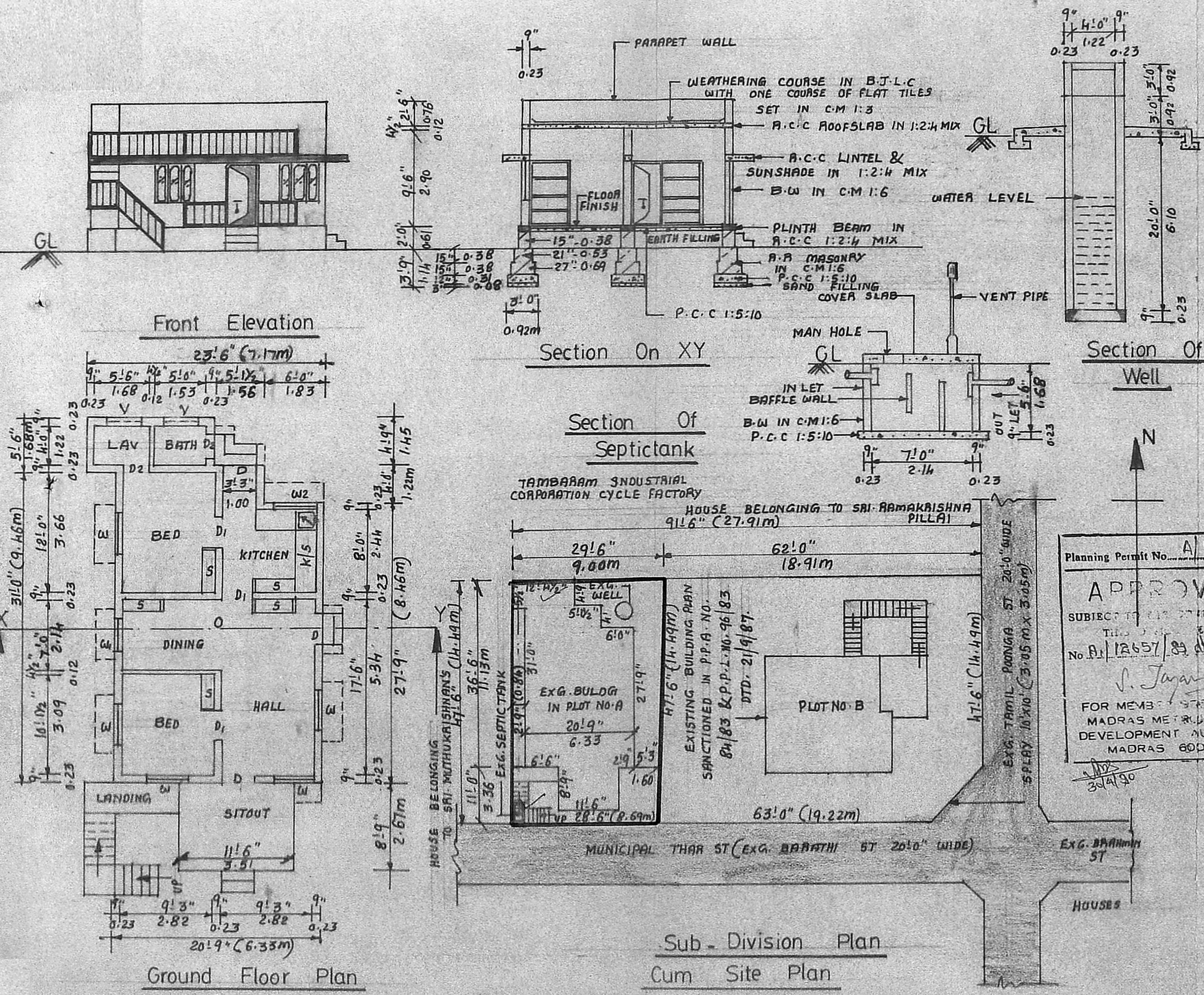

Sub - Division Plan
 Cum Site Plan